

JANE

— ENSUITE —





JANE Ensuite

The Jane Ensuite cabinets are ideal for the small bathroom or powder room. With the finger pull door and drawer profile they add a simple elegance to any bathroom. Cabinets are ensuite depth 360mm unit and come complete with a plinth attached and Legs included for an alternate style.

White gloss cabinets or textured oak cabinets.

Soft close doors, full extension standard drawer runners.

Available in 600, 750, sizes. Right hand drawer only.

Choice of Mini Ceramic console top.

Solid surface bench top options in 20mm, choice of colours.

Choice of Ceramic basins



Ceramic basins



MINI ERIN

310mm x 310mm x 110mm



EGG

415mm x 330mm x 140mm



MINI ANITA

320mm x 110mm



MINI CRUZE

370mm x 250mm x 110



Mini Ceramic top available
600 mm and 750 mm
Full ceramic top

Plug and waste not supplied

20MM SOLID SURFACE BENCH TOP COLOURS



PEBBLE



WHITE

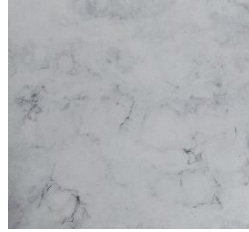

BMW



SLATE

Printing processes impose limitations on exact colour reproductions. Images are representative of colours only . Actual colour should be checked at your local stockist

What is Solid Surface

Solid surface is a man-made, non-porous composite material comprising of acrylic resins, polyester resins and pigments, it is extremely durable, hygienic and repairable. Solid Surface is easy to maintain in the home and has been a trusted material in the Bathroom and Kitchen Industry for many years.

Solid Surface has the look of stone and is **100% Silica free**

Ledin

AUSTRALIA

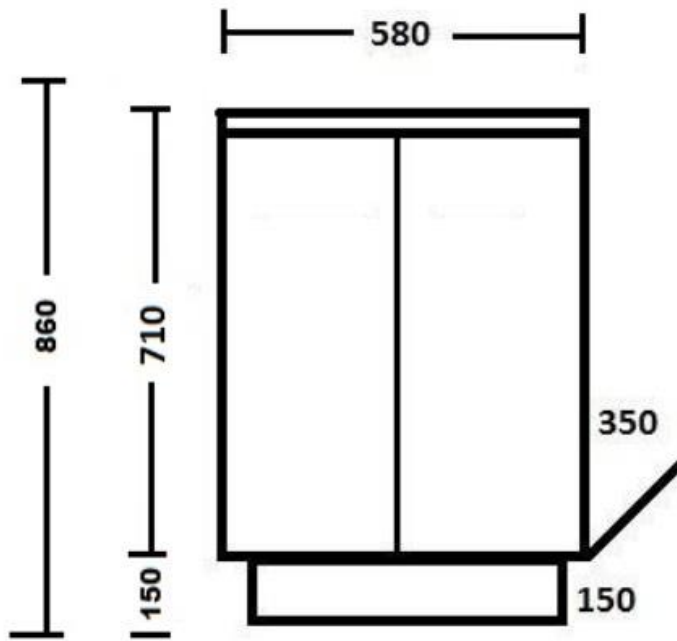

600 JANE ENSUITE



LEGS
150mm HIGH

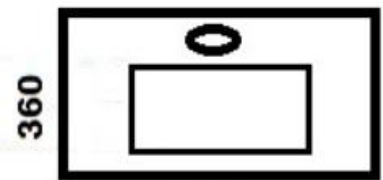

600

Ledin

AUSTRALIA

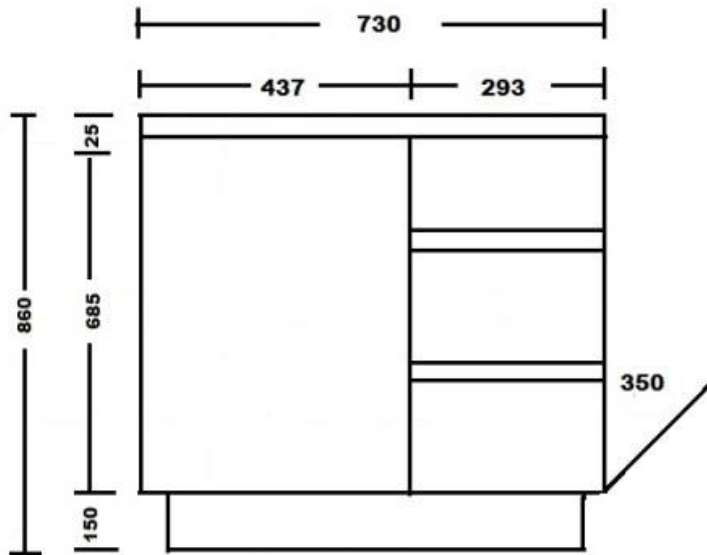

750 JANE ENSUITE CABINET

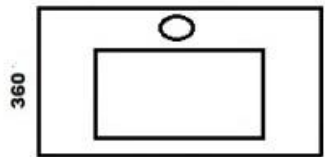
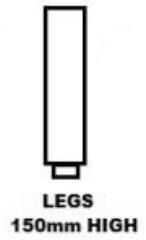

750



**Unit 11, 274 -276 Hoxton Park Rd Prestons NSW
All mail to P.O Box 364 Padstow NSW 2211
Fax: 02 858 289 81**

Email: sales@ledinaustralia.com.au

Website: www.ledinaustralia.com.au

Warranty information

Ledin Australia Pty Ltd warrants the products we distribute for the period of five years from the date of purchase. Ledin Australia Pty Ltd will at its discretion, pursuant to its obligations under the competition and consumers act 2010: repair or replace the defective product or parts.

ALL ITEMS MUST BE INSPECTED THOROUGHLY BEFORE INSTALLATION. FOR FAULTS OR DAMAGE. IF A FAULT IS FOUND IMMEDIATELY NOTIFY LEDIN AUSTRALIA OR YOUR PLACE OF PURCHASE. THE ITEM MUST NOT BE INSTALLED WITHOUT AUTHORITY FROM LEDIN AUSTRALIA PTY LTD. NO CLAIMS WILL BE ACCEPTED WITHOUT THIS AUTHORITY

This warranty does not cover damage by improper installation, neglect or misuse, improper care and maintenance, water damage and natural causes such as sunlight or excessive humidity. It should be noted that all cabinets are manufactured from water resistant materials but are **not waterproof**. All care must be taken immediately to dry any spillage of water that may gain entry to the cabinet. All claims for warranty should be reported to the original place of purchase with a copy of purchase receipt. Cabinets must not be affixed in by tiles, and cabinets must be installed in such a way that they can be removed if required without disturbing any tiles. Cabinets must be protected from water from baths and showers by protective screens. **CABINETS MUST BE SCREWED TO THE WALL**

Regulation 90 of the ACL 2010 states: Our goods come with guarantees that that cannot be excluded under the Australian consumer law. You are entitled to a replacement or refund for a major failure and for compensation for any other reasonably foreseeable loss or damage. You are also entitled to have the goods repaired or replaced if the goods fail to be of acceptable quality and the failure does not amount to a major failure.